

Schutzvermerk nach DIN34 beachten

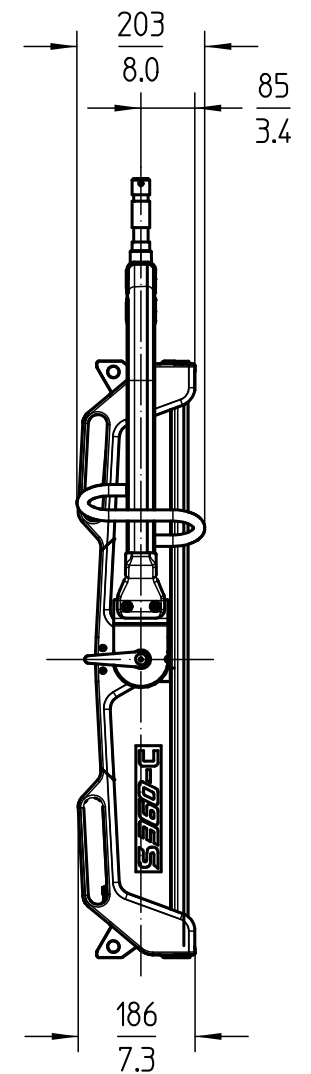
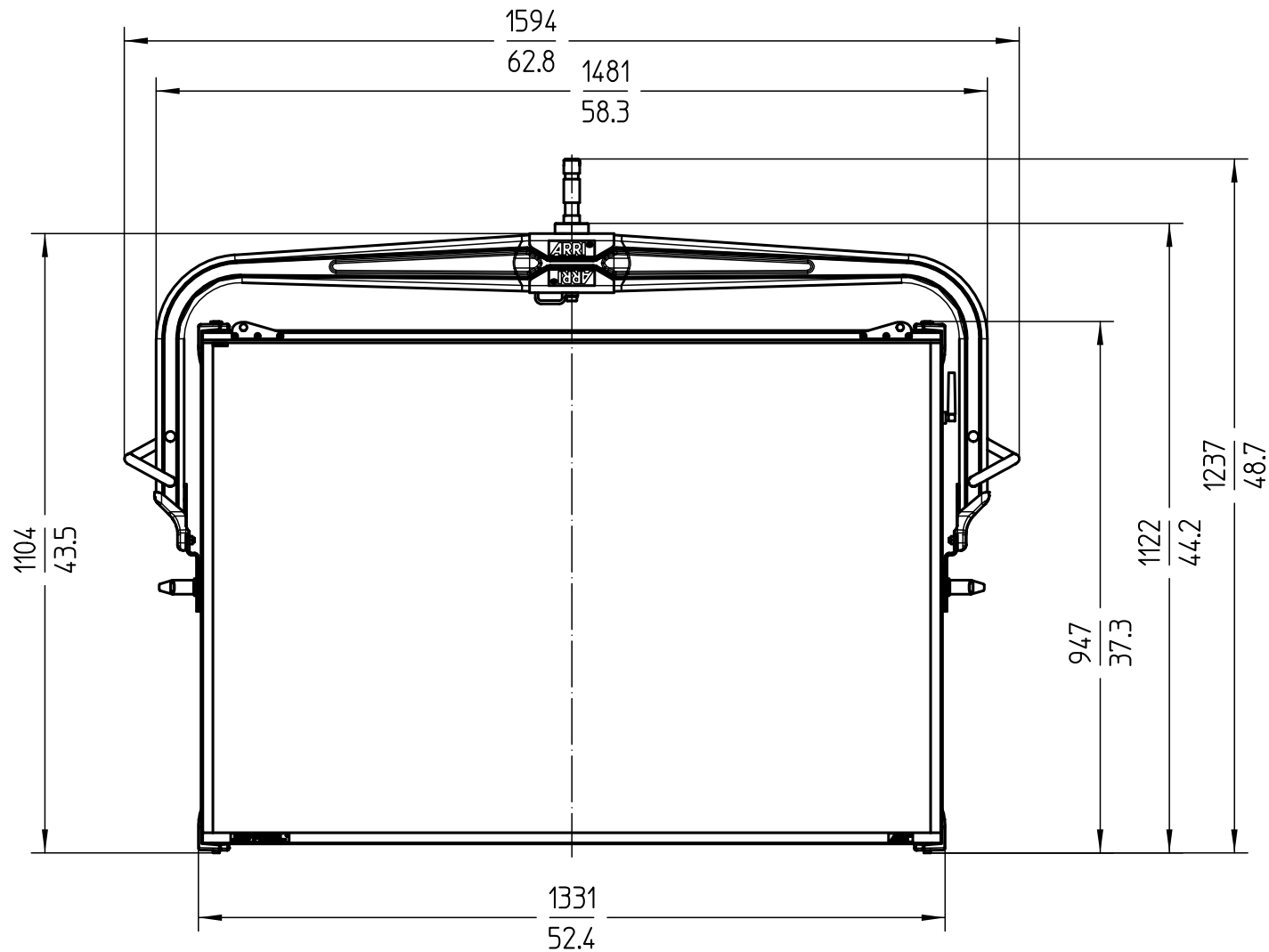

Scheinwerfertype type of lamphead	S360-C Manual	Packmass packed size	1900 x 1070 x 390 mm 74.8 x 42.1 x 15.4 "	Bezeichnung description		Gewicht weight		Packgewicht packed weight		<div>ARRI</div> <div>Arnold & Richter Cine Technik Pulvermuehle D-83071 Stephanskirchen</div>
Leuchtmittel lamp	ARRI LED-Engine	Packvolumen packed volume	793 l 28.0 ft³							
		Anmerkung / notes		Ident Nr.	Version	kg	lbs.	kg	lbs.	
		Gewicht inklusive Bügel, Zapfen und Netzkabel		L0.0016326	Schuko	43,4	95,7	75,0	165,0	
				L0.0016325	Edison	43,4	95,7	75,0	165,0	
				L0.0016327	Chinese	43,4	95,7	75,0	165,0	
Zubehör Einschub accessories slot	1317 x 911 x 2 mm 51,9 x 35,9 x 0,08 "	Weight includes yoke, spigot and mains cable (Int. = Intensifier)		L0.0016331	Int. Schuko	46,1	101,6	78,0	172,0	
Diffusor diffusion	1315 x 909 x 16 mm 51,8 x 35,8 x 0,63 "	Version / Stand version / as at...	2.0 / 15.01.2018	L0.0016330	Int. Edison	46,1	101,6	78,0	172,0	
				L0.0016332	Int. Chinese	46,1	101,6	78,0	172,0	